



ASSEMBLY INSTRUCTION

speakON® TXX Series

Lockable 4 pole Loudspeaker Cable Connector with metal housing

IMPORTANT SAFETY INSTRUCTION

“CAUTION: NOT FOR INTERRUPTING CURRENT”

“ATTENTION: NE PAS UTILISER POUR COUPER LE COURANT”

Attention: speakON® is not to be used as an AC mains or power supply connector!

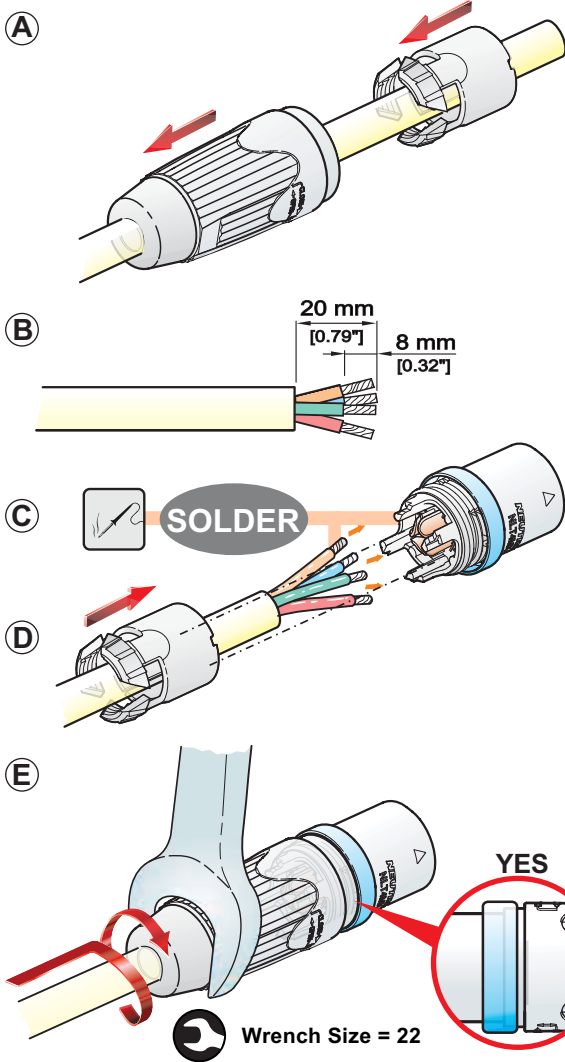

Assembly of the Cable Connector

- A Place bushing and chuck over the cable.
- B Prepare cable as shown.
- C Solder the wire ends to contacts of insert.
- D Slide the chuck up the cable and align with the housing.
- E Slide the bushing up the cable and tighten it (flat wrench SW 22 mm).

Important: Bushing must be screwed onto housing minimum 3 turns thus there is no gap between housing and bushing.

Wiring of the Male Cable Connector:

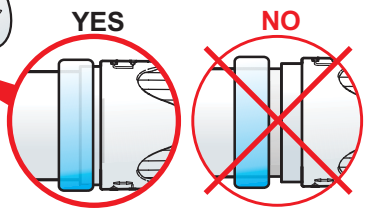
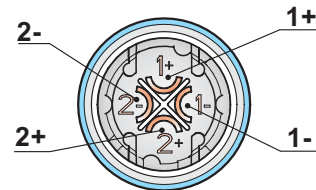

Wiring of the Female Receptacle and the Cable Connector:

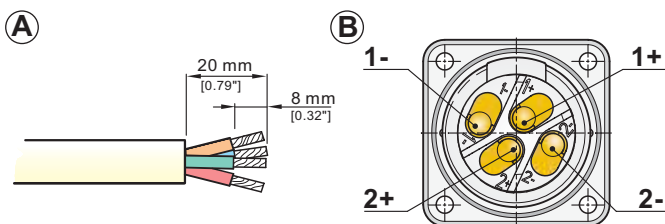

- A Prepare cable as shown.
- B Insert the wires into the terminals and solder it.

Neutrik AG LI T: +423 / 237 24 24 F: +423/232 53 93
 Neutrik USA Inc. USA T: +1 704 / 972 3050 F: +1 704/438 9202
 Neutrik (UK) Ltd. UK T: +44 1983 / 811 441 F: +44 1983/811 439
 Neutrik Vertriebs GmbH DE/NL/AT/DK T: +49 8131 / 280 890 F: +49 8131/280 830

Neutrik France FR T: +33 1/4131 6750 F: +33 1/4131 0511
 Neutrik Tokyo Ltd. JP T: +81 3/3663 4733 F: +81 3/3663 4796
 Neutrik Hong Kong Ltd. HK T: +852/2687 6055 F: +852/2687 6052
 Neutrik India Pvt. Ltd. IND T: +91/982 05 43 424 F: +91/22 26163 540

Draft. Nr.: BDA 614 V2 | Update: 2021-02-18 Data subject to change without prior notice. © 2020 NEUTRIK®. NEUTRIK® are registered trademark of Neutrik AG. ALL RIGHTS RESERVED.